

# **INSTALLATION OF ACCESS CONTROL SYSTEM ON MAIN APARTMENT DOOR**

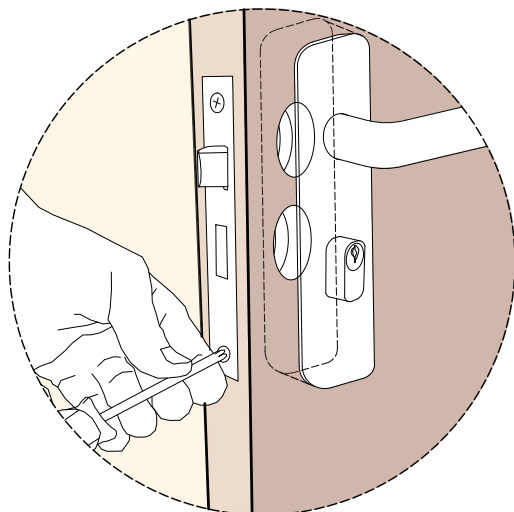

## **CAREFULLY REMOVE THE EXISTING LOCKSET**

UNSCREW AND GENTLY REMOVE THE OLD HANDLE AND LOCK COMPONENTS. AVOID DAMAGING THE DOOR SURFACE OR FRAME WHILE REMOVING SCREWS OR PRYING PARTS LOOSE. KEEP ANY REMOVED HARDWARE ASIDE SAFELY IN CASE RESTORATION IS NEEDED LATER.

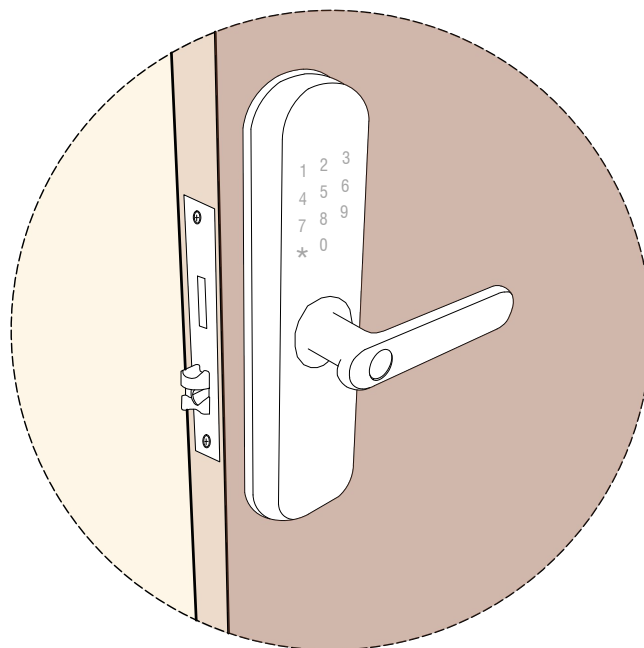

## **ELECTRIC DOOR LOCK SYSTEM**

### **CHECK COMPATIBILITY**

ENSURE THE ELECTRONIC LOCK SYSTEM FITS THE EXISTING DOOR LOCK CUT-OUT DIMENSIONS. CONFIRM THAT THE DOOR THICKNESS AND FRAME STRUCTURE SUPPORT THE NEW LOCK SET.

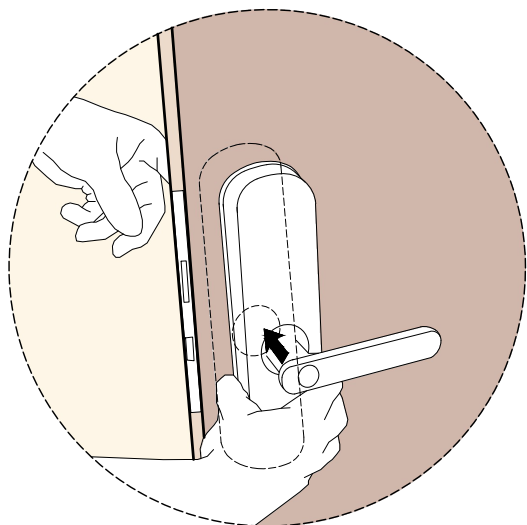

## **INSPECT THE DOOR LEAF, DOOR FRAME AND CUT-OUTS**

CHECK THE DOOR'S CONDITION AFTER REMOVING THE OLD LOCK. ENSURE THE EXISTING CUT-OUT MATCHES THE ELECTRONIC LOCK'S REQUIREMENTS. DO NOT ATTEMPT TO CUT ANY PARTS OF THE DOOR WITHOUT INFORMING TO FDC RESPECTIVE DEPARTMENT.

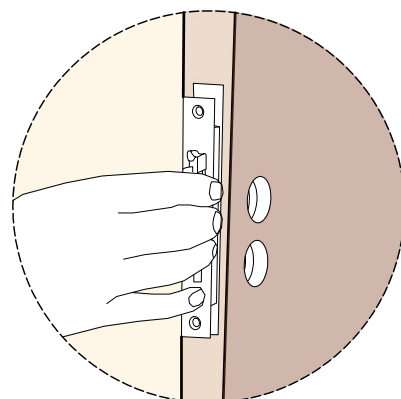
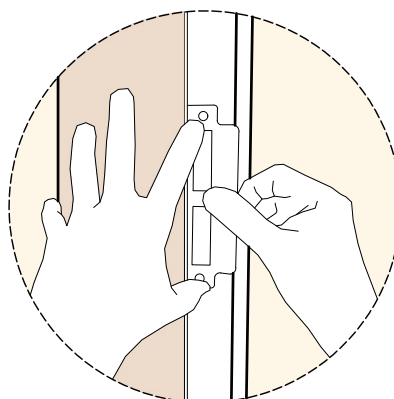

## **INSTALL THE ELECTRONIC LOCK SET**

FOLLOW THE MANUFACTURER'S INSTALLATION GUIDE STEP BY STEP. ALIGN THE ELECTRONIC LOCK PRECISELY WITH THE EXISTING CUT-OUT AND SCREW IT IN SECURELY WITHOUT OVERTIGHTENING. ENSURE THE LOCK MECHANISM OPERATES SMOOTHLY BEFORE FINAL TIGHTENING.

## **OTHER INSTRUCTIONS:**

### **TEST THE LOCK FUNCTIONALITY**

TEST ALL FUNCTIONS: LOCKING, UNLOCKING, KEYPAD OR FINGERPRINT SCANNER (IF AVAILABLE), AND EMERGENCY KEY OVERRIDE. CONFIRM THE DOOR OPENS AND CLOSSES PROPERLY WITHOUT RESISTANCE.

### **FINAL CHECKS**

ENSURE THERE ARE NO LOOSE PARTS OR EXPOSED WIRING. CLEAN THE DOOR SURFACE FROM DUST OR FINGERPRINTS. VERIFY THAT THE INSTALLATION HAS NOT CAUSED ANY DAMAGE TO THE DOOR OR FRAME.